

# LSIS USA Bulletin

## Coil Change Process for MC/MR Contactor

### Purpose

This document shows the proper disassembly and re-assembly for the LSIS MC/MR Contactors in order to change the coil. If there is a situation where a coil is damaged and needs to be replaced or simply a different coil voltage is needed for a MC/MR contactor, please follow the instructions in this document.

### Table of Contents

MC Frame 18AF-22AF.....	<a href="#">Page 1</a>
MR Frame 4-8.....	<a href="#">Page 1</a>
MC Frame 40AF-150AF.....	<a href="#">Page 3</a>
MC Frame 225AF-800AF.....	<a href="#">Page 6</a>

### Coil Removal Process (MC Frame 18AF-22AF and MR Frame 4-8)

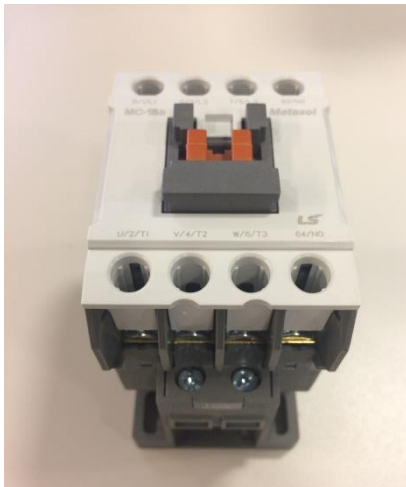

1. Remove the contactor from the box and set the contactor on a flat surface.



2. There may be a nameplate label on the seam. If there is, cut the label along the seam before step 3.

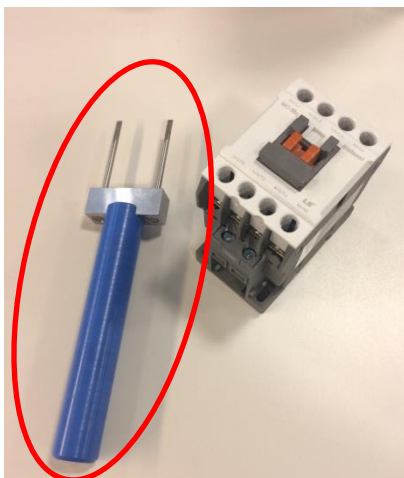

3. Use the LSIS contactor tool (if available) to separate the top half of the contactor from the bottom. Alternatively, a small flat bladed screwdriver will work.

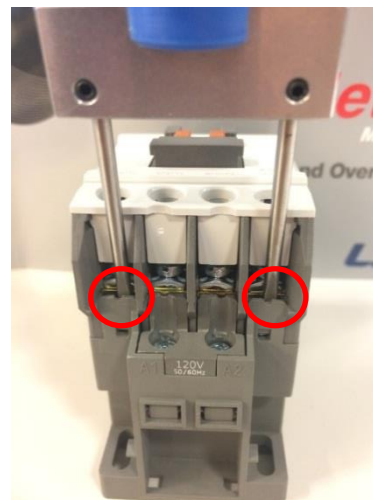

3a. Insert the blades into the plastic tabs as shown.

# LSIS USA Bulletin

## Coil Change Process for MC/MR Contactor

3b. Pull the handle towards the “inside” of the contactor until the top half pops out of the tabs. Repeat for the other side

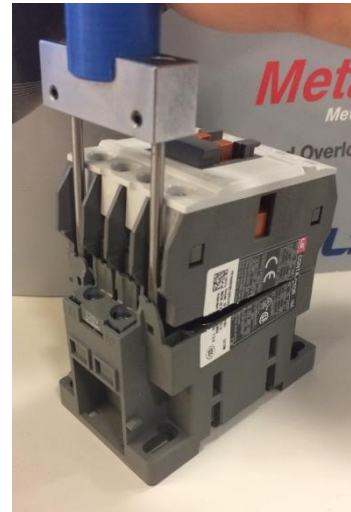
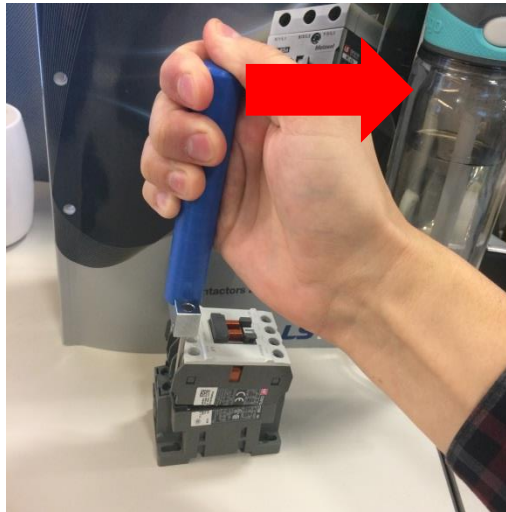

4. Remove the top half of the contactor.

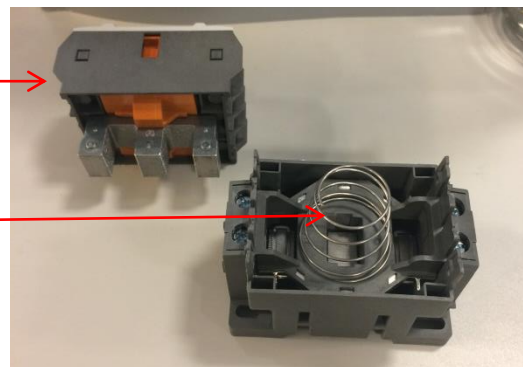

5. Remove the spring.

6. Remove the coil (it will lift out).

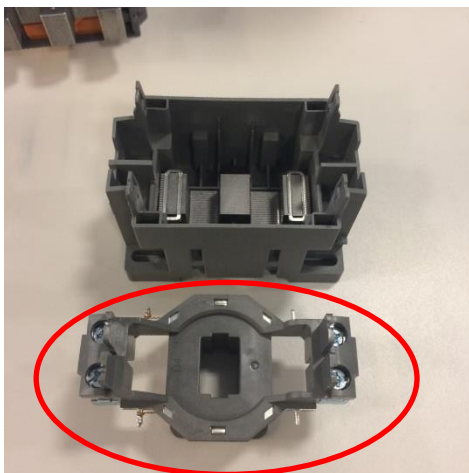

7. **Replacement Process** - Slide in the new coil, reinstall the spring (larger end down), and press the top half of the contactor into the bottom half until it clicks into place. Use the nameplate label to confirm the top and bottom half's orientation matches.

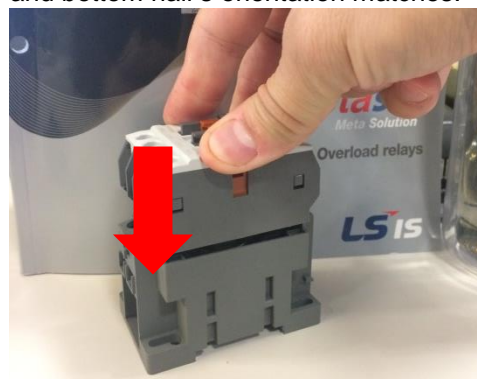

# LSIS USA Bulletin

## Coil Change Process for MC/MR Contactor

### Coil Removal Process (Frame 40AF-150AF)

1. Remove the contactor from the box.



2. Set the contactor on a flat surface.



3. If there is an Aux contactor, remove it first, otherwise skip to step 6.

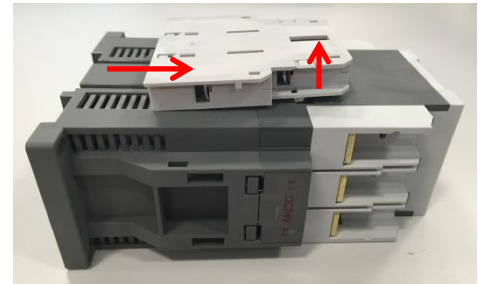

4. Remove the Aux contactor by laying the contactor on its side, pushing up on the Aux bottom with your thumbs and pulling out on the top portion with your fingers.



5. Remove the Aux contactor and repeat step 4 if there is a second Aux.



6. There may be a nameplate label on the seam. If there is, then cut the label along the seam before step 7.



7. Remove the center screw between A1 and A2. Repeat this on both sides.  
**Note: Frame 150AF has two screws on each side.**

# LSIS USA Bulletin

## Coil Change Process for MC/MR Contactor

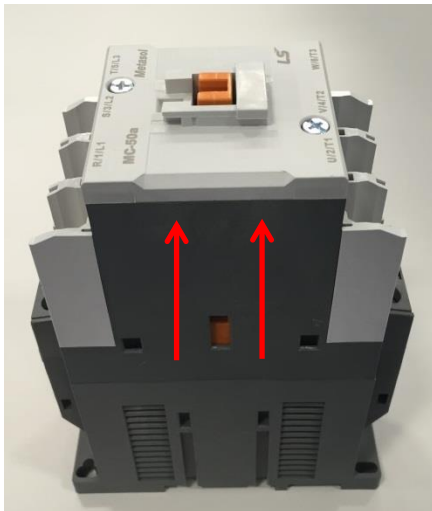

8. With the two screws removed, pull up on the top half of the contactor. It will separate from the bottom half.



9. Remove the spring.

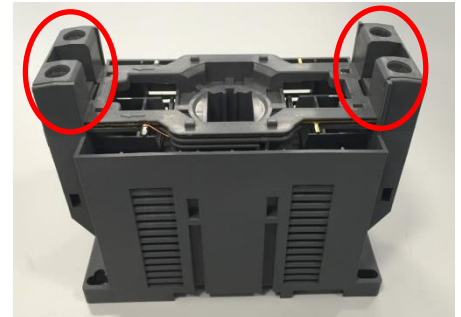

10. Remove the coil by pulling up on both sets of A1 and A2 terminals.

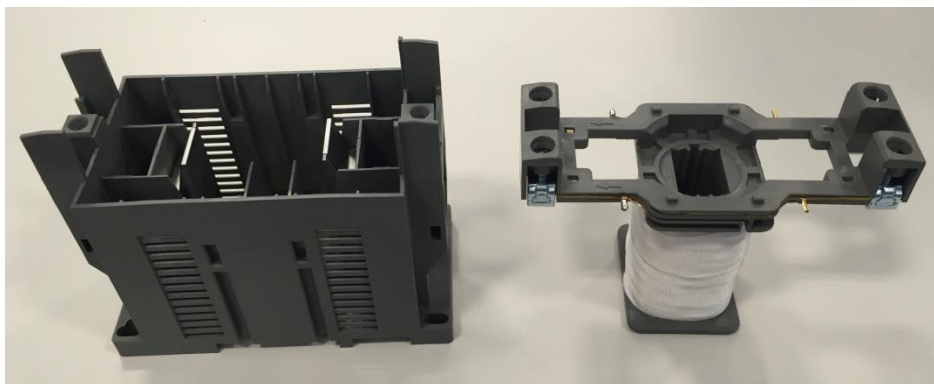

11. Complete.

# LSIS USA Bulletin

## Coil Change Process for MC/MR Contactor

### Coil Replacement Process (Frame 40AF-150AF)

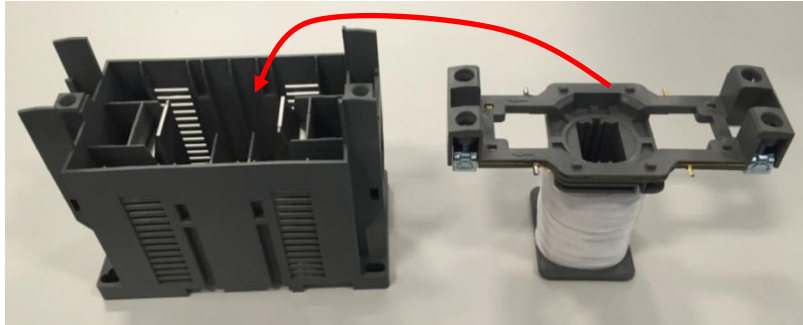

1. Place new coil in the housing.

**Note: Orientation does not matter; the coil is symmetrical.**

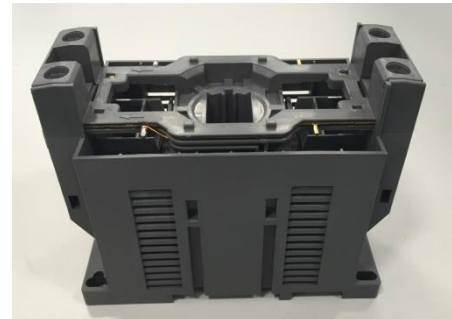

2. Coil installed.



3. Replace spring (larger end down).

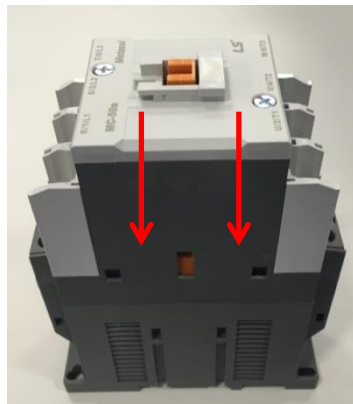

4. Replace top half.

**Note: The top should slide smoothly onto the bottom with little pressure. Rotate 180 degrees if the top cannot be fully seated easily.**



5. Replace 2 screws (be sure not to over tighten).

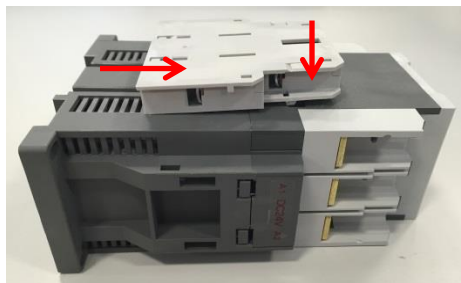

6. Replace any Aux contactors on the unit. Slide the bottom in first, push up, and then press the top portion of the Aux into the contactor base.



7. Complete.

# LSIS USA Bulletin

## Coil Change Process for MC/MR Contactor

### Coil Removal Process (Frame 225AF-800AF)



3. Remove contactor from box and lay on a flat surface.



2. Locate the contactor coil.

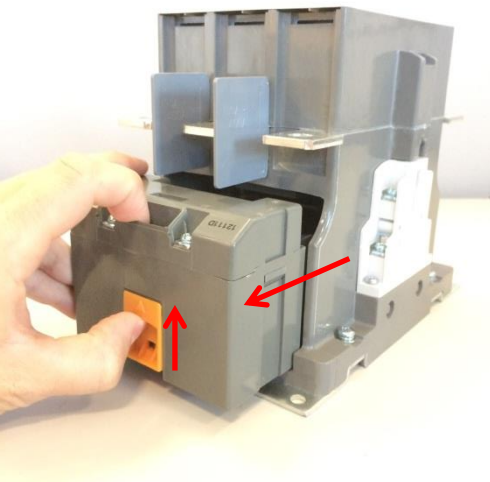

1. Lift the orange locking mechanism and slide the coil out.



4. The coil is removed

## LSIS USA Bulletin

### Coil Change Process for MC/MR Contactor

#### Coil Replacement Process (Frame 225AF-800AF)

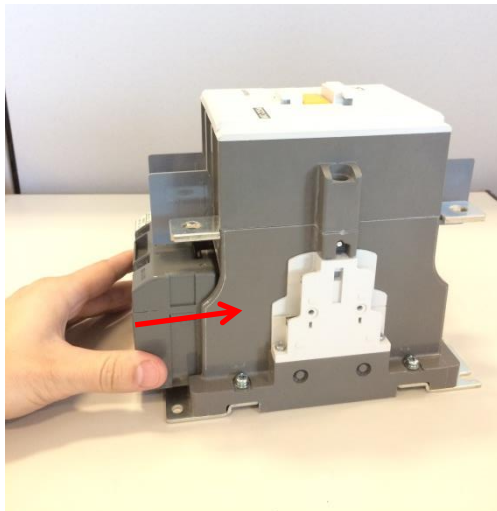

1. Slide replacement coil into contactor housing.

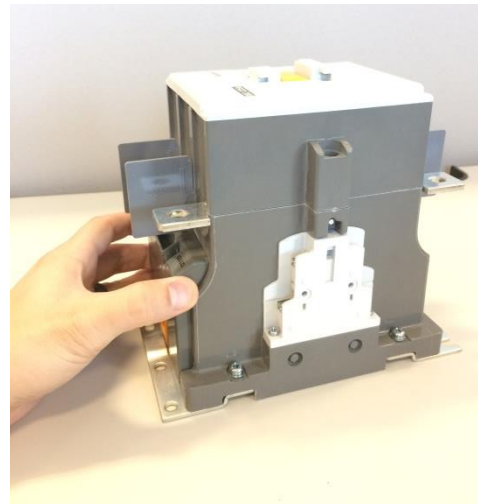

2. Push in coil until it is fully seated.  
**You will feel it click into place.**